

MAP 1 NC8 from Forsyth County Line to Pvt joint E of Dollar General, from Pvt joint S of bridge #14 to Bolejack Rd SR1961  
 Mill 0-1 1/2" incidental milling begining, end and at all SR intersections  
 Mill 0-1 1/2" at face of curb 7' width  
 Pave 1 1/2" 9.5B

MAP 2 NC8 from Bolejack Rd SR1961 to Rosebud Rd SR1945  
 Mill 1 1/2" in depth entire width  
 Pave 1 1/2" 9.5B

**STOKES COUNTY**  
 NORTH CAROLINA

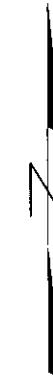
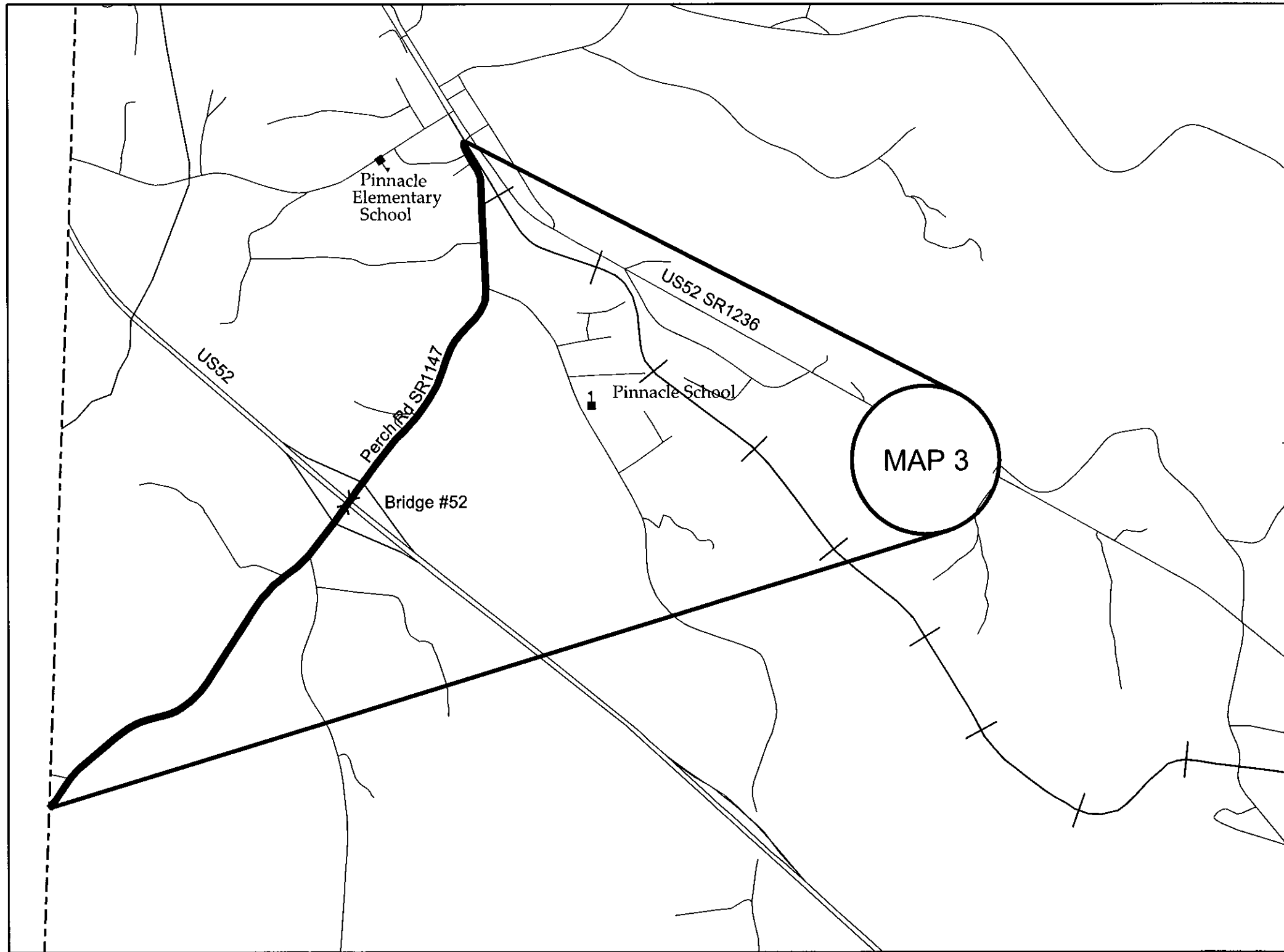

MAP 3 Perch Rd SR1147 from  
Surry County line to Pvt joint at  
RxR crossing and Old US52 SR1236  
Mill 0-1 1/2" incidental mill begining,  
end, all SR Intersections and Bridge  
#52  
Pave 1 1/2" 9.5B

**STOKES COUNTY**  
NORTH CAROLINA

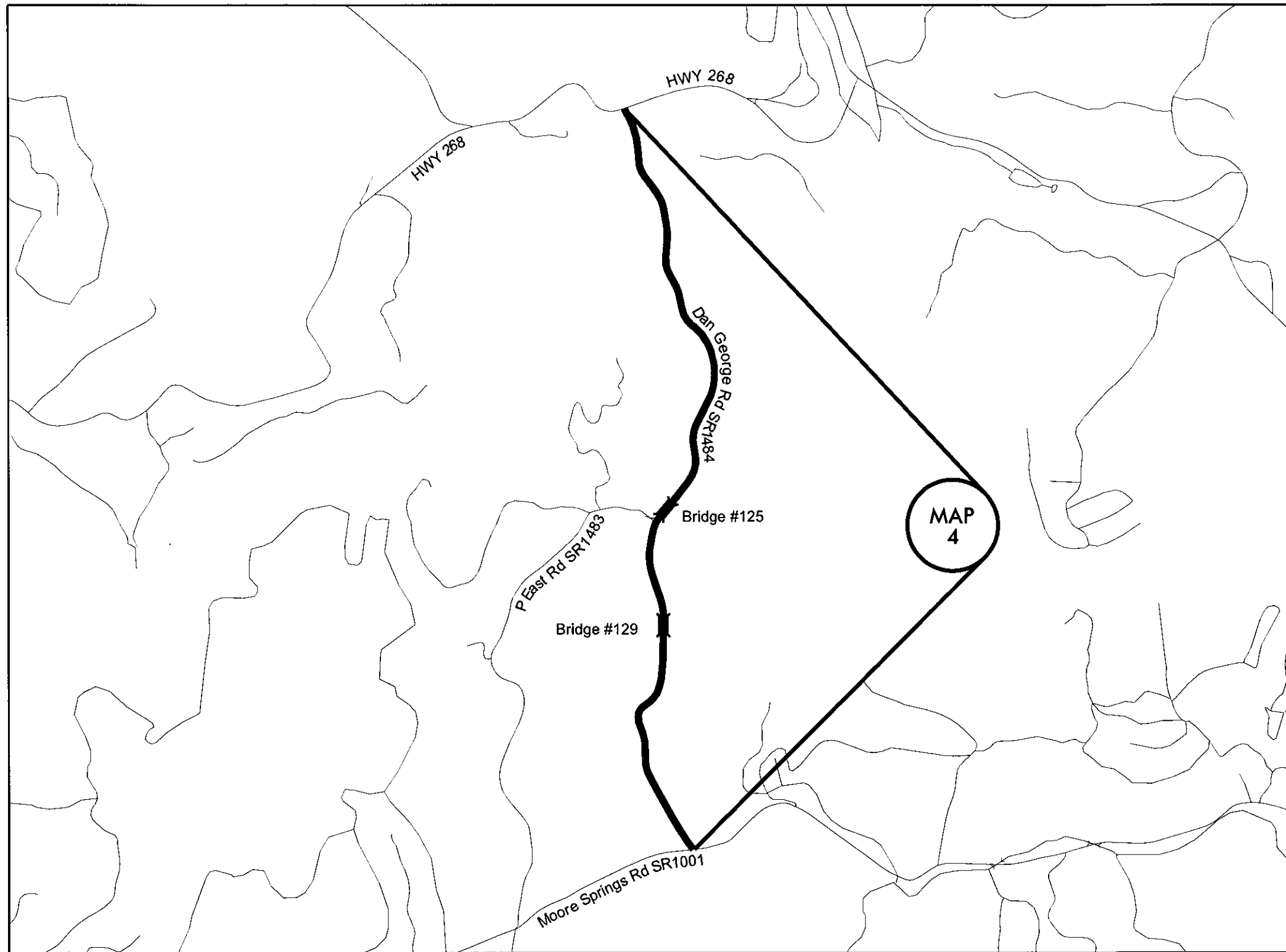

MAP 4 Dan George RD SR 1484  
From Moore Springs Rd.  
SR 1001 To HWY 268  
Mill 0-1 1/2" Incidental milling  
at begining, end, all SR  
Intersections and Bridge #125,  
#129  
Pave 1 1/2" 9.5B

PROJECT REFERENCE NO.	SHEET NO.
2021CPT.09.09.10851	4
2021CPT.09.10.20851	

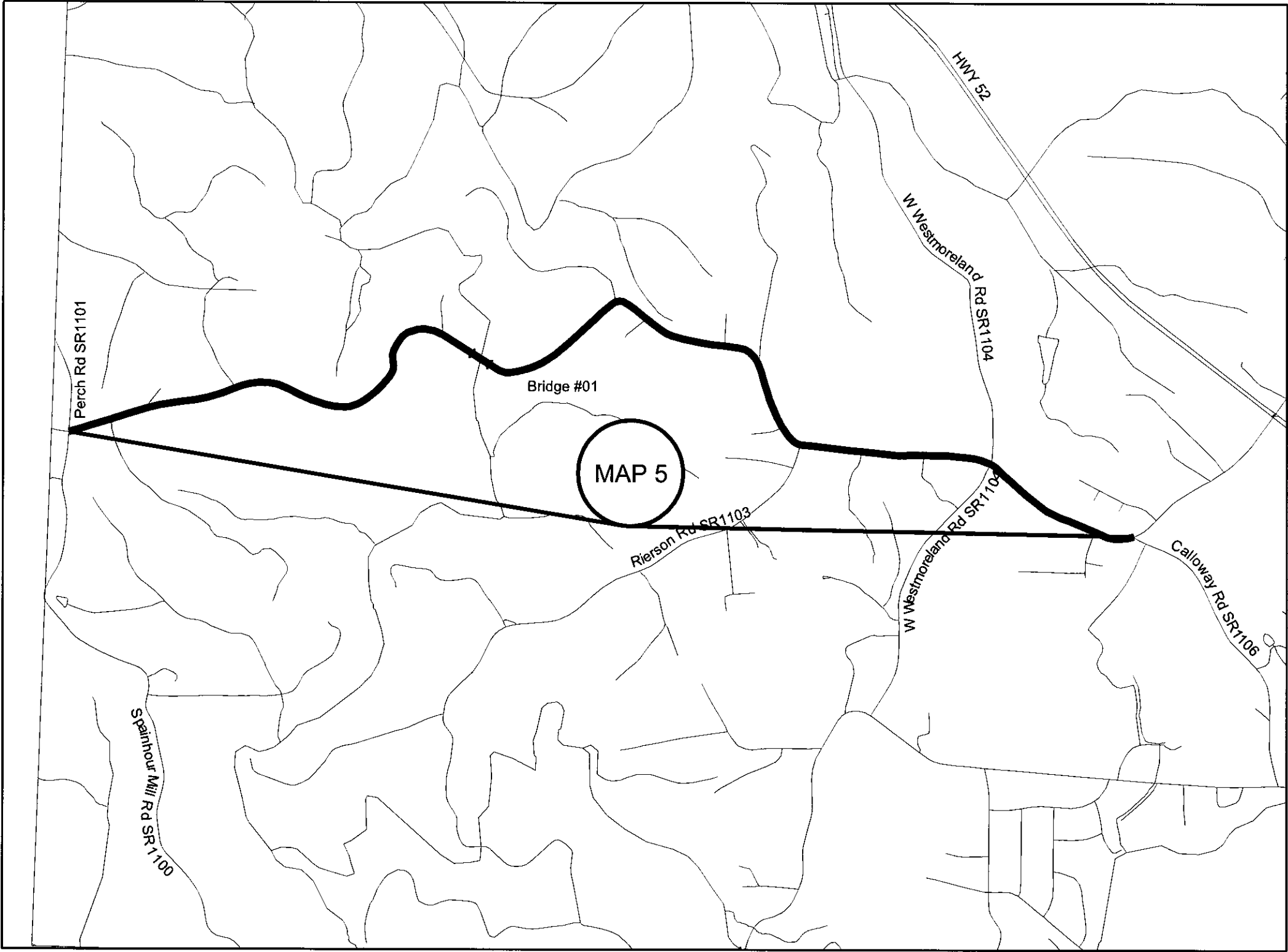

 MAP 5 Trinity Church Rd SR1102  
 from W. of Calloway Rd SR1106 to  
 Spainhour Mill Rd SR1100/ Perch Rd  
 SR1101  
 Mill 0-1 1/2" incidental mill begining,  
 end, Pvt joints at Bridge #1 and at  
 all SR intersections  
 Pave 1 1/2" 9.5B

**STOKES COUNTY**  
 NORTH CAROLINA

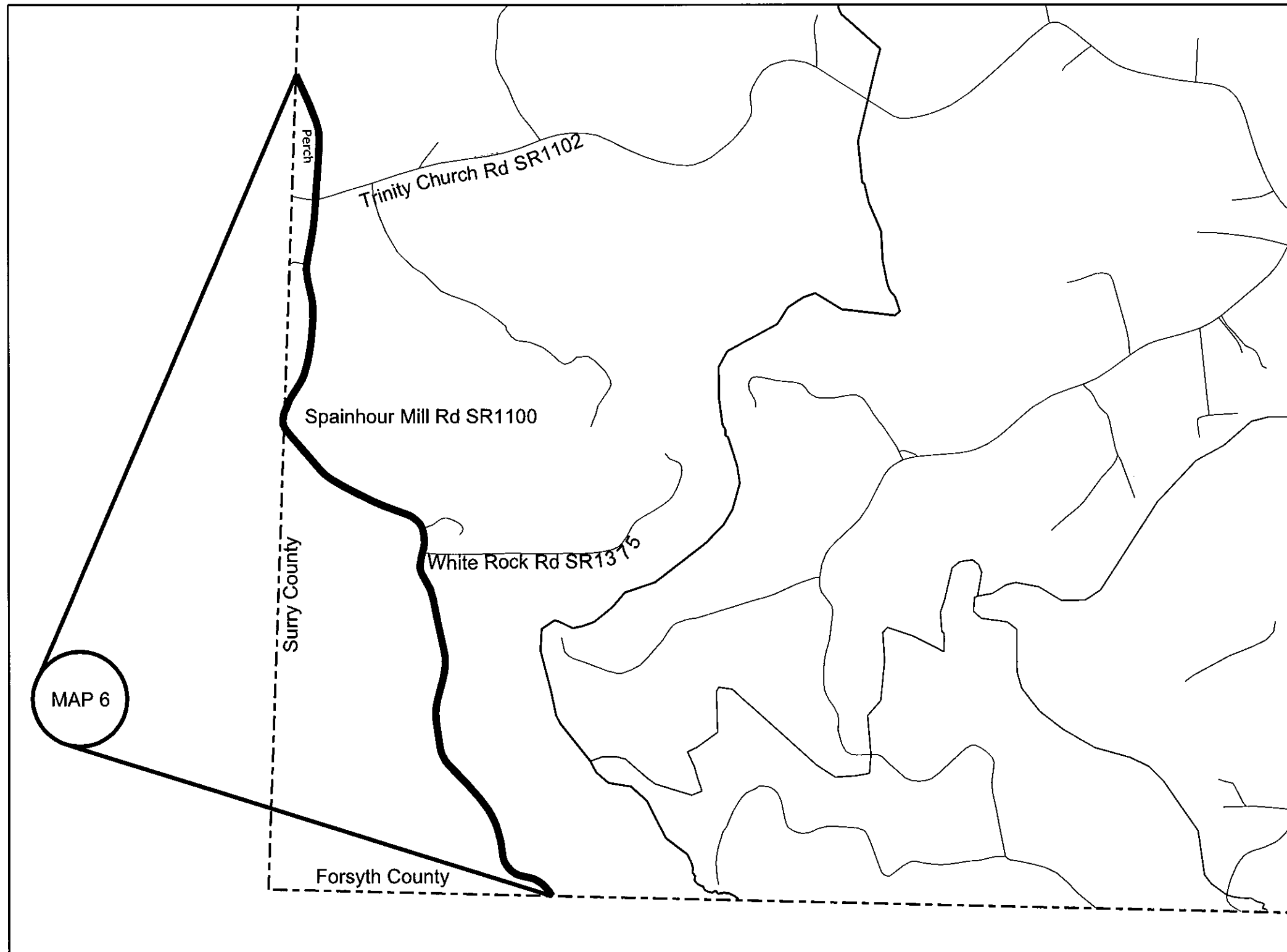

MAP 6 Spainhour Mill Rd SR  
1100 from Forsyth County  
line to Surry County Line  
Mill 0-1 1/2" incidental mill  
beginning, end and at all SR  
intersections  
Pave 1 1/2"9.5C

**STOKES COUNTY**  
NORTH CAROLINA

PROJECT REFERENCE NO.	SHEET NO.
2021CPT.09.09.10851 2021CPT.09.10.20851	6

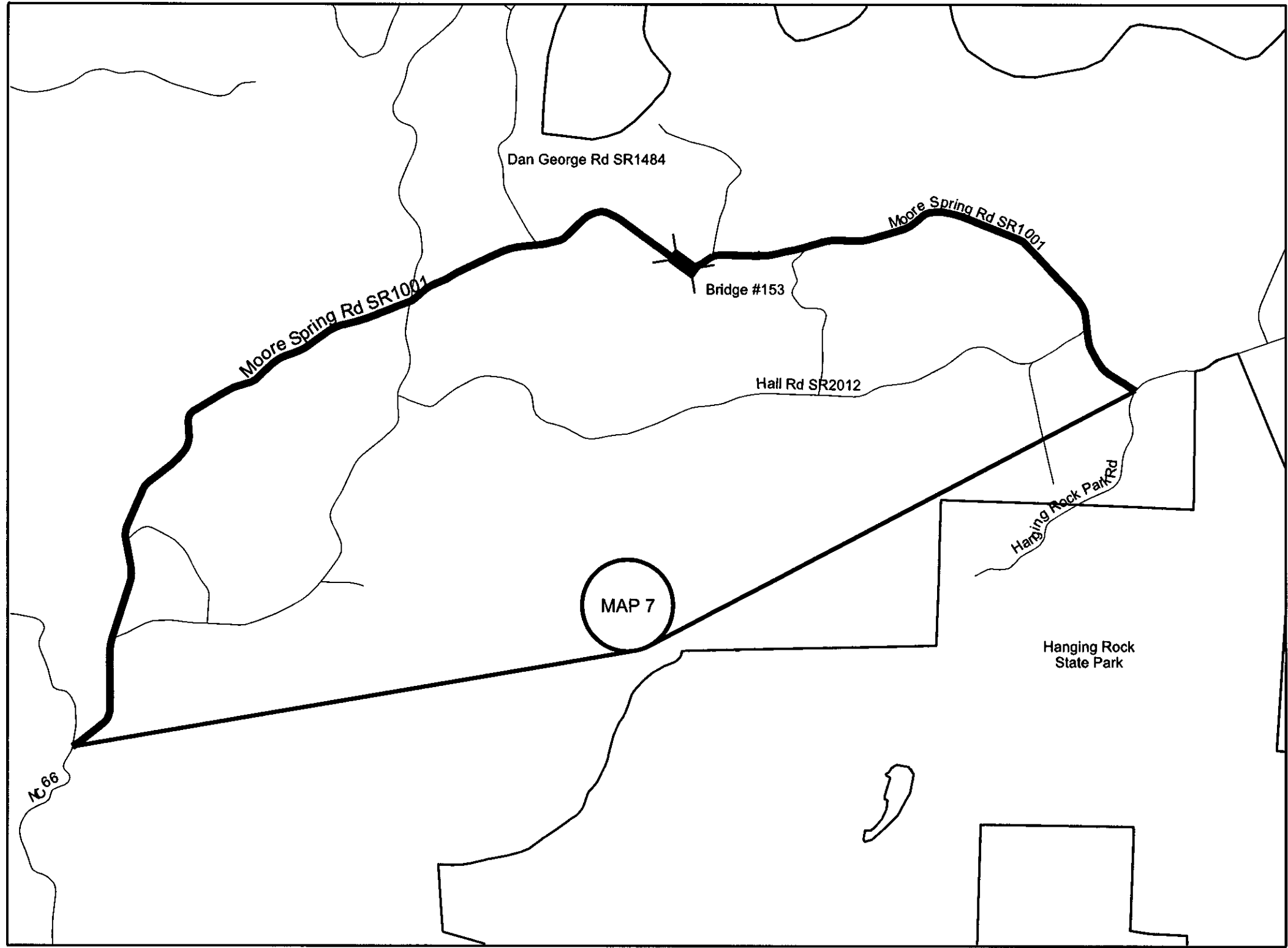

MAP 7 Moore Spring Rd SR1001 from Hanging Rock Park Rd SR2015 to NC66 Mill 0-1 1/2" incidental Mill beginning, end, Bridge #153 and at all SR intersections Pave 1 1/2" 9.5B Contractor to notify Chuck White 704-639-7563 2 weeks prior to the start of this Map

**STOKES COUNTY**  
NORTH CAROLINA

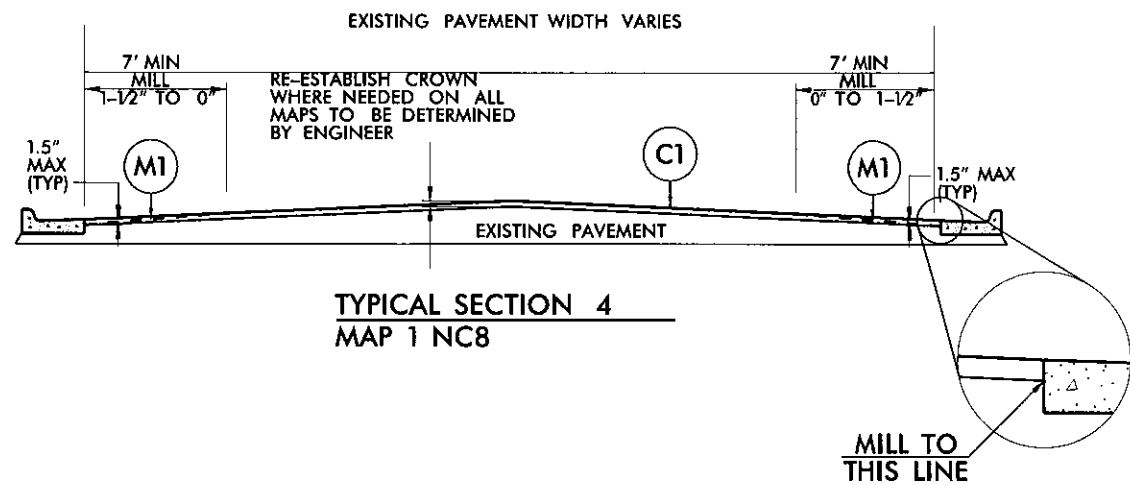
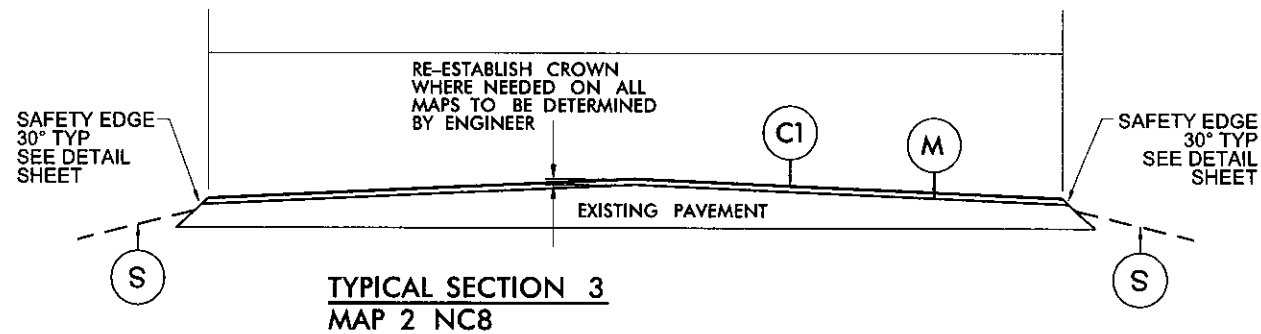
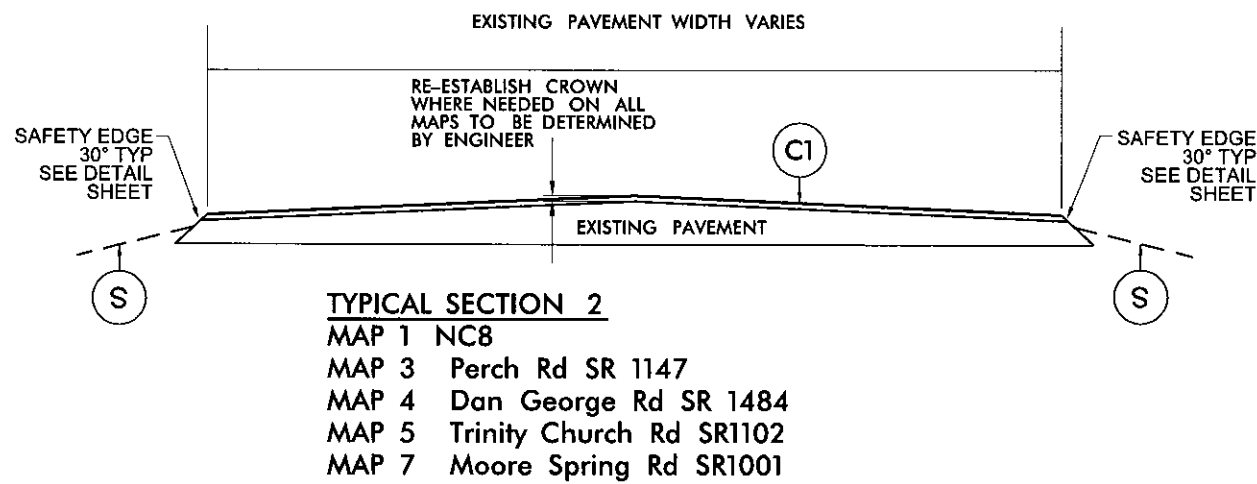
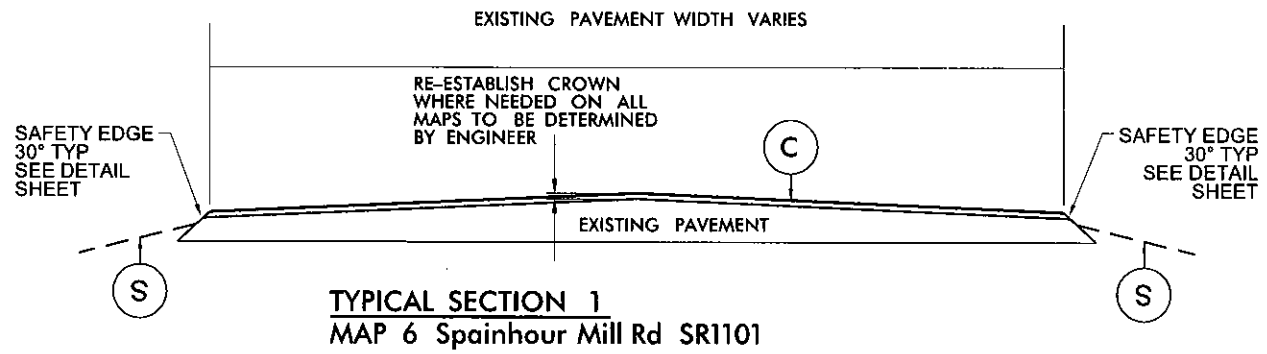

PAVEMENT SCHEDULE	
C	PROP. APPROX. 1½" ASPHALT CONCRETE SURFACE COURSE, TYPE S9.5C, TO BE APPLIED AT AN AVERAGE RATE OF 168 LBS PER SQ YD.
C1	PROP. APPROX. 1½" ASPHALT CONCRETE SURFACE COURSE, TYPE S9.5B, TO BE APPLIED AT AN AVERAGE RATE OF 165 LBS PER SQ YD.
M	MILL ASPHALT PAVEMENT, 1½" DEPTH ENTIRE WIDTH
M1	MILL ASPHALT PAVEMENT, 0" TO 1½"
S	SHOULDER RECONSTRUCTION (SEE DETAIL)
U	EXISTING PAVEMENT

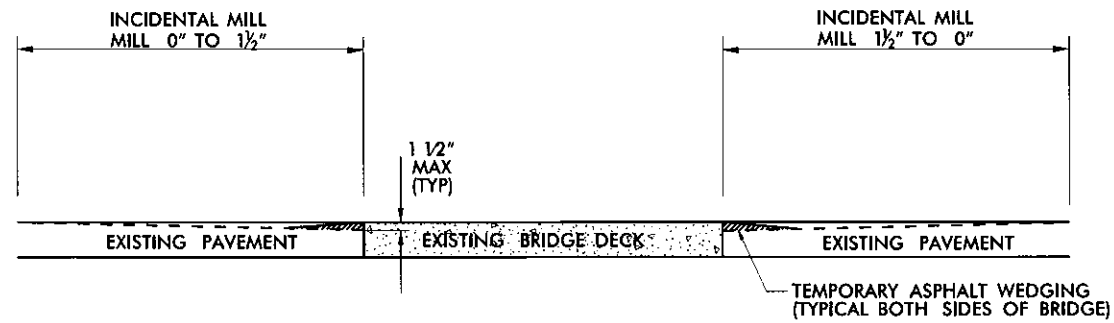

**INCIDENTAL MILLING  
BRIDGE APPROACHES**  
(SEE BRIDGE DATA SHEET)

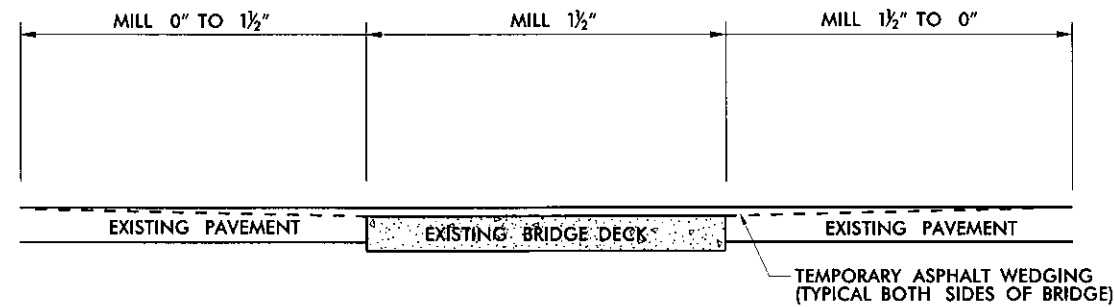

**INCIDENTAL MILLING  
BRIDGE APPROACHES**  
(SEE BRIDGE DATA SHEET)

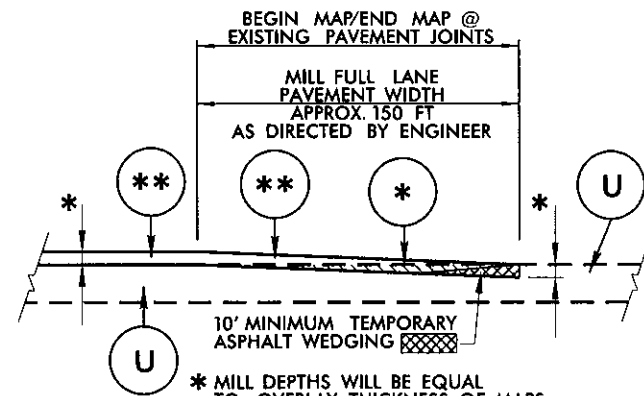

- \* MILL DEPTHS WILL BE EQUAL TO OVERLAY THICKNESS OF MAPS SEE TYPICALS AND BRIDGE DATA SHEETS
- \*\* MILL SR. Y-LINES APROX. 50' AS DIRECTED BY ENGINEER
- \*\*\* SEE TYPICALS FOR MIX TYPE

**INCIDENTAL TIE-IN MILLING DETAIL**

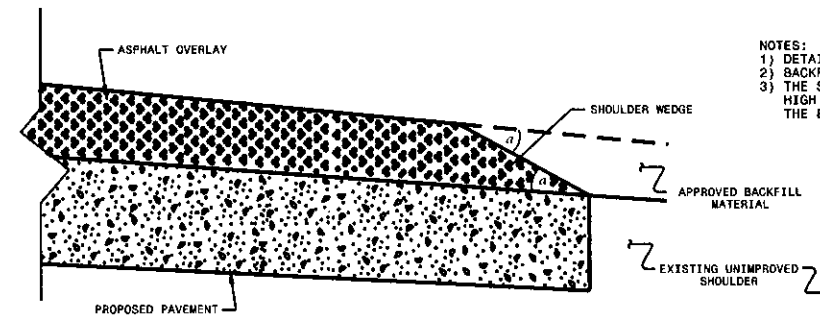

**SHOULDER WEDGE DETAIL**  
(Resurfacing Projects w/ Widening or with Existing Paved Shoulder having no dropoffs)

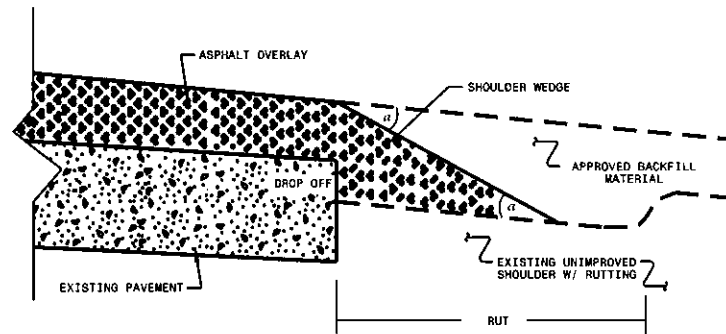

**SHOULDER WEDGE DETAIL**  
(Resurfacing Adjacent to Rutted Shoulder)

- NOTES:  
1) DETAIL DOES NOT APPLY TO DGAF AND ULTRA-THIN BONDED WEARING COURSE.  
2) BACKFILL SHOULDER WITH APPROVED MATERIAL.  
3) THE SHOULDER WEDGE DEVICE MAY BE DISENGAGED AT PAVED DRIVEWAYS AND SIDE STREETS, HIGH SHOULDERS, AND OTHER LOCATIONS NOT FEASIBLE TO CONSTRUCT AS DIRECTED BY THE ENGINEER.

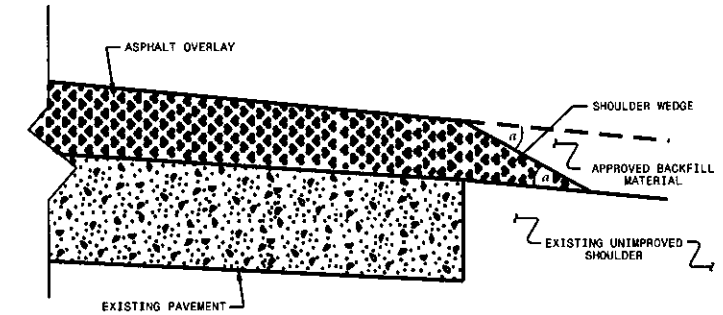

**SHOULDER WEDGE DETAIL**  
(Resurfacing Projects w/ NO Widening)

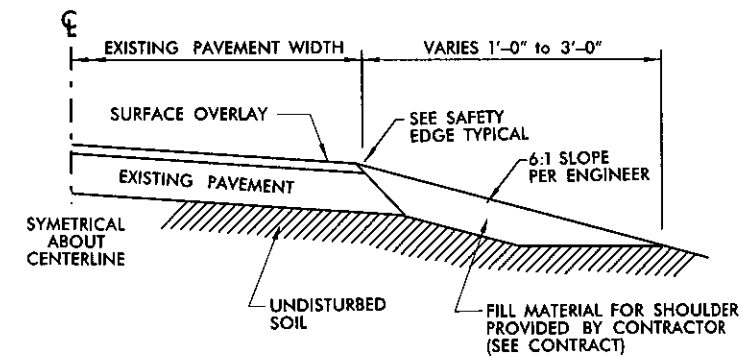

**SHOULDER RECONSTRUCTION**



## CONSTRUCTION NOTES:

1. ALL QUANTITIES ARE "ESTIMATED" AS INDICATED IN THE "SUMMARY OF QUANTITIES".

2. CONSTRUCTION SHALL PROGRESS IN PHASES, IN THE ORDER INDICATED BELOW:

- PHASE 1 - MILLING AND PATCHING (WHEN REQUIRED)  
 PHASE 2 - SURFACE OVERLAY  
 PHASE 3 - SHOULDER DROP-OFF REPAIR (AS NEEDED AND DIRECTED BY ENGINEER)  
 PHASE 4 - UTILITY ADJUSTMENTS (MANHOLE RING/COVER, VALVE/METER BOX RING/COVER, CATCH BASIN GRATE/COVER, DROP INLET GRATE/COVER, ETC.) WHEN REQUIRED.

3. BRIDGES THAT HAVE FLOOR DRAINS, SHALL HAVE ALL FLOOR DRAINS LEFT OPEN. EXTRA CARE SHALL BE EXERCISED IN MILLING (IF REQUIRED) AND IN PLACING THE WEARING SURFACE AROUND FLOOR DRAINS SO AS NOT TO HINDER EFFECTIVE DRAINAGE.

4. TEMPORARY ASPHALT WEDGING SHALL BE PLACED ON THE SAME DAY THAT BRIDGE AND/OR RAILROAD APPROACHES ARE MILLED (AND IF APPROACHES ARE MILLED PRIOR TO BRIDGE DECK).

5. FOR TWO-LANE ROADWAYS - IT SHALL BE UNDERSTOOD THAT TYPICALLY ON A ROADWAY MEASURING 20 FEET OR LESS IN WIDTH, THE CENTER OF THE WHITE EDGELINE SHALL BE LOCATED SIX INCHES FROM THE EDGE OF PAVEMENT ON EITHER SIDE OF THE ROADWAY; ON A ROADWAY MEASURING 22 FEET IN WIDTH, TRAVEL LANES SHALL MEASURE 10 FEET AND THE WHITE EDGELINE SHALL BE LOCATED ONE FOOT FROM THE EDGE OF PAVEMENT ON EITHER SIDE; ON A ROADWAY MEASURING 24 FEET IN WIDTH, TRAVEL LANES SHALL MEASURE 11 FEET AND THE WHITE EDGELINE SHALL BE LOCATED ONE FOOT FROM THE EDGE OF PAVEMENT ON EITHER SIDE; ON A ROADWAY MEASURING 26 FEET OR MORE IN WIDTH, TRAVEL LANES SHALL MEASURE 12 FEET AND THE WHITE EDGELINE SHALL BE LOCATED NO LESS THAN ONE FOOT FROM THE EDGE OF PAVEMENT ON EITHER SIDE. THIS SHALL BE STANDARD PRACTICE UNLESS OTHERWISE DIRECTED BY THE ENGINEER.

6. PAPER JOINTS ARE TO BE PLACED BETWEEN DAYS OF PAVING OPERATIONS AS SPECIFIED IN THE STANDARD SPECIFICATIONS SECTION 610-11.

7. ALL MILLED AREAS WILL BE PAVED WITHIN 72 HOURS UNLESS APPROVED BY THE ENGINEER.

8. REPLACE ANY PORTION OF STOP BARS AND OTHER PAVEMENT MARKINGS AT ANY INTERSECTION INCLUDING Y-LINES NOT ACTUALLY BEING PAVED OVER, THAT ARE OBLITERATED BY THE PAVING OPERATION EITHER BY HAULING WHEEL TRACKS OR TACK TRUCK BY THE END OF EACH RESURFACING OPERATION

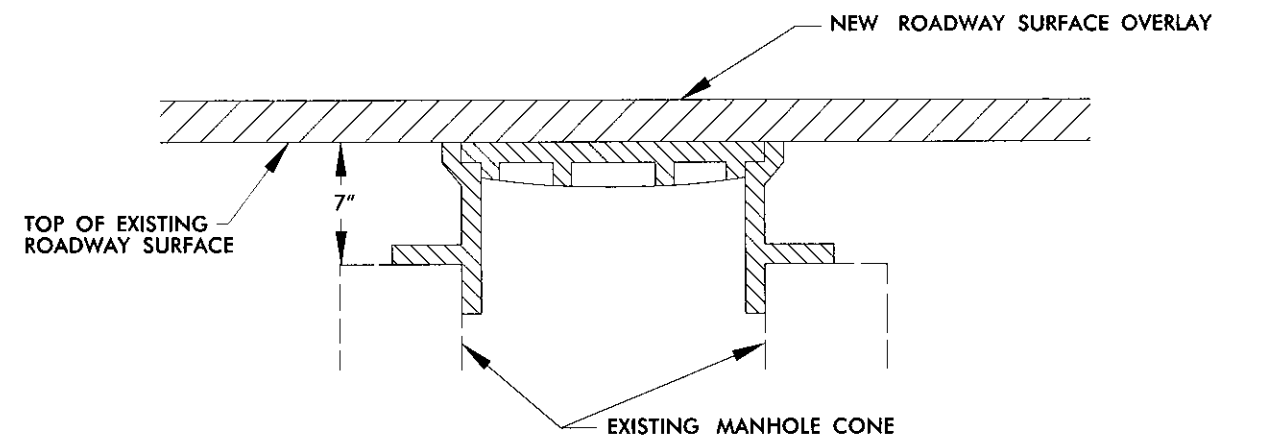

STEP 1

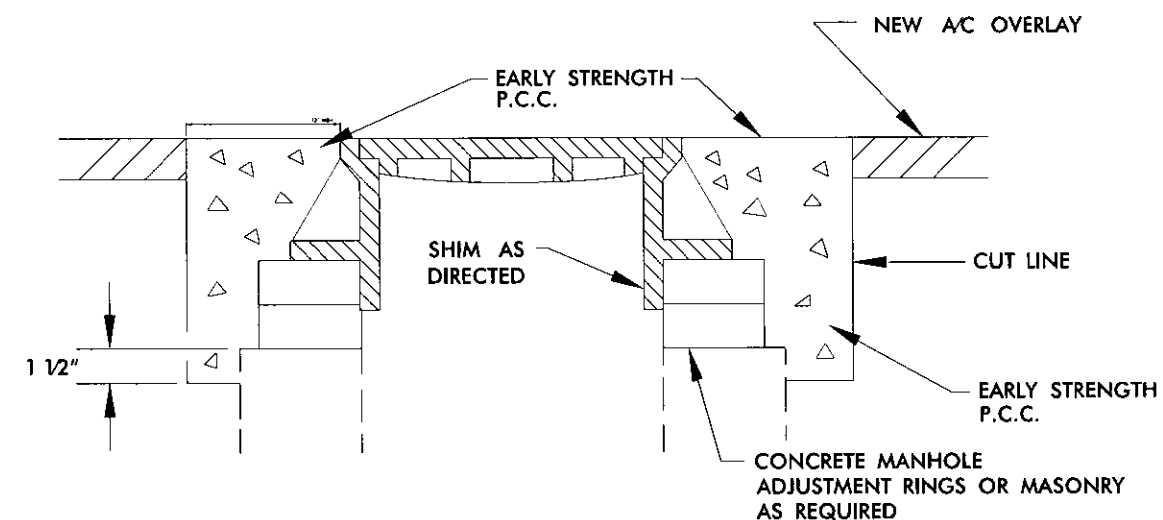

STEPS 2,3, &amp; 4

- STEP 1 COVER EXISTING MANHOLE WITH APPROVED MATERIAL AND CONSTRUCT OVERLAY ACROSS TOP OF MANHOLE
- STEP 2 SAW CUT EXCAVATION AROUND MANHOLE 12" MIN. FROM MANHOLE FRAME.
- STEP 3 RAISE MANHOLE FRAME RINGS TO FINISH PAVEMENT PROFILE AND CROSS SLOPE.
- STEP 4 BACKFILL WITH EARLY STRENGTH P.C.C. TO DEPTHS AS DIRECTED.

## MANHOLE ADJUSTMENT DETAIL

NOTES: Less than 5' - 10' undisturbed buffer from ROW, ditchline, water feature, or drainage inlet, add BMP.

BMP Options: Wattle or Silt Fence

# EROSION CONTROL DETAIL

PROJECT REFERENCE NO.	SHEET NO.
2021CPT.09.09.10851 2021CPT.09.10.20851	10

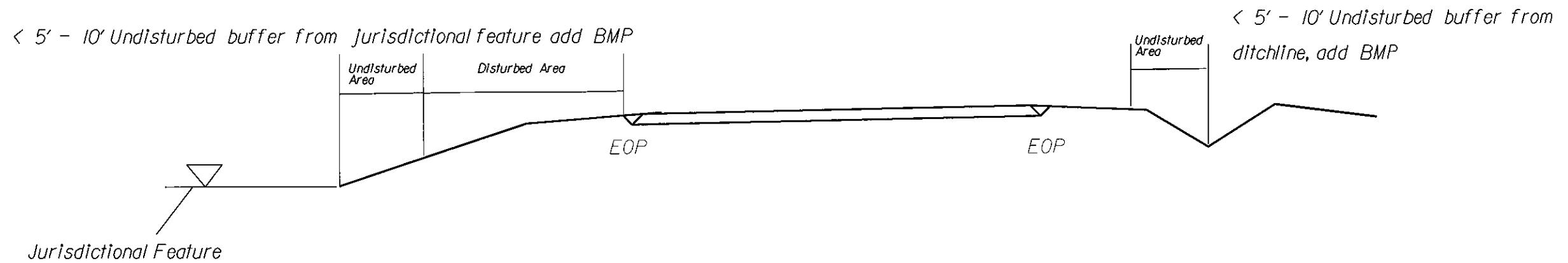
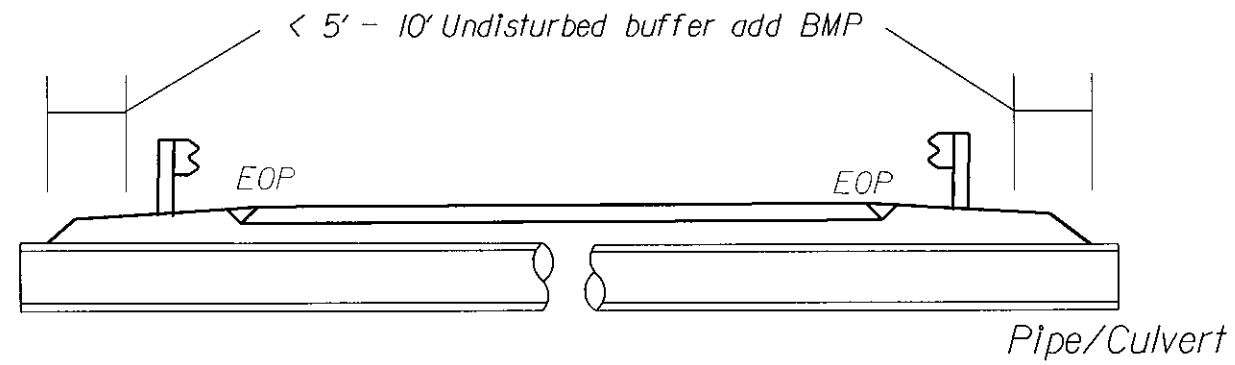

Use BMP's if shoulders and/or front slopes and/or ditchline and/or backslopes are disturbed

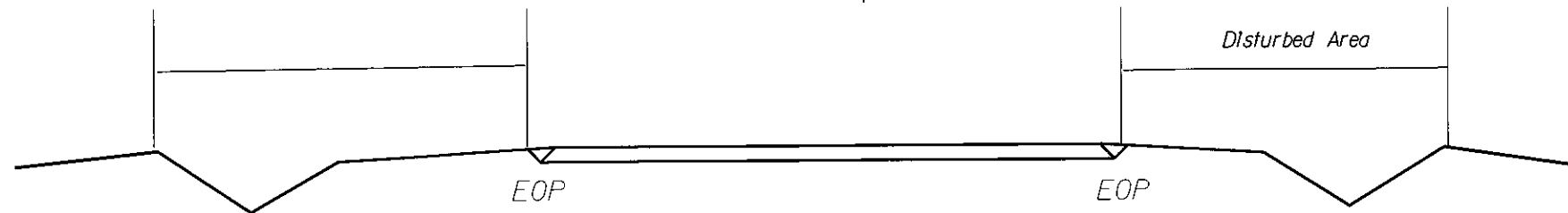

< 5' - 10' Undisturbed buffer from inlet, add wattle

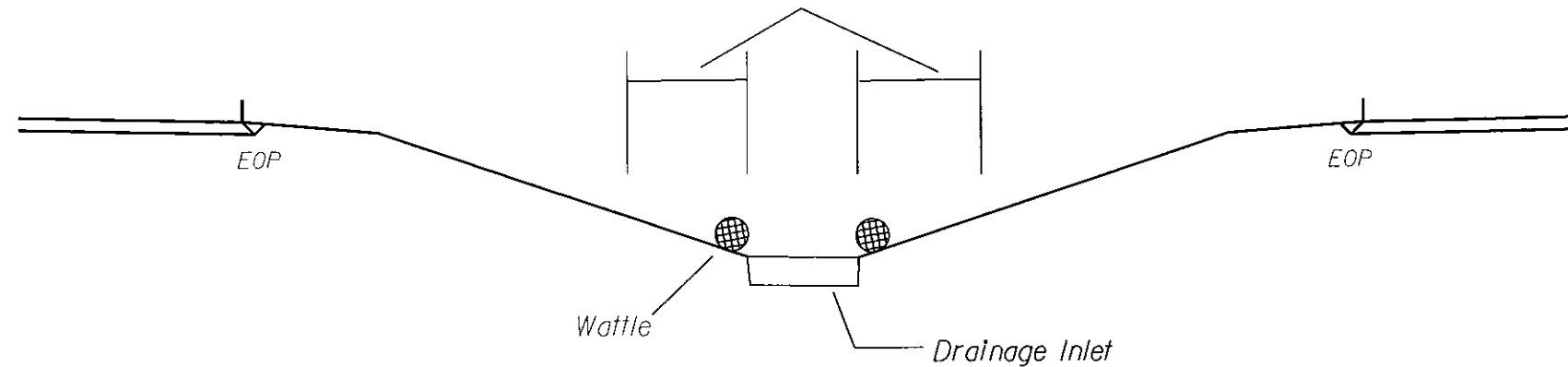

NOT TO SCALE

# BRIDGE DATA

									PROJECT NO.		SHEET NO.	
									2021CPT.09.09.10851		11	
									2021CPT.09.10.20851			
Map No.	Route No.	Route Name	Bridge No.	Feature Intersected	Floor Construction	Clear Roadway Width (Ft)	Horizontal Clearance Under (Ft.)	Vertical Clearance Under	Length (Ft)	Posting	Recommended Treatment, From Bridge Maintenance	
1	NC8	NC8	14	Town Fork Creek	9" RC SLAB	33.81	NA	NA	222	NA	Do NOT pave on bridge, incidental mill on both sides	
1	NC8	NC8	44	Town Fork Creek Overflow	PPCCS,5.5" CWS	33.417	NA	NA	100	NA	Do NOT pave on bridge, incidental mill on both sides	
5	SR1102	Trinity Church Rd	1	Little Yadkin River	7" RC Slab	24	NA	NA	151	NA	Do NOT pave on bridge, incidental mill on both sides	
3	SR1147	Perch Rd	52	US52 SBL US52 NBL	7 3/4" RC SLAB	28	NA	NA	212	NA	Do NOT pave on bridge, incidental mill on both sides	
4	SR1484	Dan George Rd	129	South Double Creek	AWS	30.5	NA	NA		NA	Mill and pave back same thickness Bridge built in 2018	
4	SR1484	Dan George Rd	125	North Double Creek	PPC.BB/3.5" AWS	30.5	NA	NA	102	NA	Mill and pave back same thickness Bridge built in 2018	
7	SR1001	Moore Spring Rd	153	Cascade Creek	5 GA. STL. 1.5"AWS	22.417	NA	NA	144	NA	Mill and pave back same thickness, Contractor to notify Chuck White 704-639-7563 2 weeks prior to the start of this Map	

PROJECT NO.	SHEET NO.	TOTAL NO.
2021CPT.09.09.10851	12	
2021CPT.09.10.20851	12	

### SUMMARY OF QUANTITIES

PROJECT NO	COUNTY	MAP NO	ROUTE	DESCRIPTION	TYP NO	LANES	LANE TYPE	FINAL SURFACE TESTING REQUIRED	WARM MIX ASPHALT REQUIRED	LENGTH	WIDTH	0106000000-E	1220000000-E	1245000000-E	1297000000-E	1308000000-E	1330000000-E	1519000000-E	1523000000-E	1575000000-E	1704000000-E	2830000000-N	2845000000-N	6000000000-E	6071010000-E		
												BORROW EXCAVATION	INCIDENTAL STONE BASE	SHOULDER RECONSTRUCTION	MILLING ASPHALT PAVEMENT, 1 1/2" DEPTH	MILLING ASPHALT PAVEMENT, 0" TO 1 1/2" DEPTH	INCIDENTAL MILLING	SURFACE COURSE, S9.5B	SURFACE COURSE, S9.5C	ASPHALT BINDER FOR PLANT MIX	PATCHING EXISTING PAVEMENT	ADJ. OF MANHOLES	ADJ. OF METER OR VALVE BOX	TEMPORARY SILT FENCE	WATTLE		
												MI	FT	CY	TONS	SMI	SY	SY	SY	TONS	TONS	TONS	TONS	EA	EA	LF	LF
2021CPT.09.09.10851	Stokes	1	NC8	FROM FORSYTH COUNTY LINE TO PVT JOINT E DOLLAR GENERAL, FROM PVT JOINT S BRIDGE#14 TO BOLEJACK RD SR1961	2,4	2,3	2WU	NO	NO	3.826	24	459	250	15.30		778	3,900	5,283		354	10	1	1	1,530	153		
TOTAL FOR MAP NO. 1											3.826		459	250	15.30		778	3,900	5,283		354	10	1	1	1,530	153	
2021CPT.09.09.10851	Stokes	2	NC8	FROM BOLEJACK RD SR 1961 TO ROSEBUD RD SR 1945	3	2,3	2WU	NO	NO	1.875	24	225	125	3.75	27,000			2,463		165	10			750	75		
TOTAL FOR MAP NO. 2											1.875		225	125	3.75	27,000			2,463		165	10			750	75	
TOTAL FOR PROJ NO. 2021CPT.09.09.10851											5.701		684	375	19.05	27,000	778	3,900	7,746		519	20	1	1	2,280	228	
2021CPT.09.10.20851	Stokes	3	PERCH RD SR1147	FROM SURRY COUNTY LINE TO OLD US52 SR1236	2	2	2WU	NO	NO	1.937	22	232	130	3.87			2,221	2,493		167	10			775	77		
TOTAL FOR MAP NO. 3											1.937		232	130	3.87			2,221	2,493		167	10			775	77	
2021CPT.09.10.20851	Stokes	4	DAN GEORGE RD SR 1484	FROM MOORE SPRINGS RD SR1001 TO NC268	2	2	2WU	NO	NO	1.856	21	223	36	3.71			2,100	2,087		140	15			742	74		
TOTAL FOR MAP NO. 4											1.856		223	36	3.71			2,100	2,087		140	15			742	74	
2021CPT.09.10.20851	Stokes	5	TRINITY CHURCH RD SR1102	FROM W OF CALLOWAY RD SR1106 TO SPAINHOUR MILL RD SR1100/PERCH RD SR1101	2	2	2WU	NO	NO	3.317	22	398	130	6.63			1,799	3,997		268				1,327	133		
TOTAL FOR MAP NO. 5											3.317		398	130	6.63			1,799	3,997		268				1,327	133	
2021CPT.09.10.20851	Stokes	6	SPAINHOUR MILL RD SR1101	FROM FORSYTH COUNTY LINE TO SURRY COUNTY LINE	1	2	2WU	NO	NO	1.934	21	4	130	3.87			1,033		2,246	135				774	77		
TOTAL FOR MAP NO. 6											1.934		4	130	3.87			1,033		2,246	135				774	77	
2021CPT.09.10.20851	Stokes	7	MOORE SPRING RD SR1001	FROM HANGING ROCK PARK RD SR2015 TO NC66	2	2	2WU	NO	NO	5.377	20	645	125	10.75			2,039	5,858		392				2,151	215		
TOTAL FOR MAP NO. 7											5.377		645	125	10.75			2,039	5,858		392				2,151	215	
TOTAL FOR PROJ NO. 2021CPT.09.10.20851											14.421		1,502	551	28.83			9,192	14,435	2,246	1,102	25			5,769	576	
GRAND TOTAL											20.122		2,186	926	47.88	27,000	778	13,092	22,181	2,246	1,621	45	1	1	8,049	804	

Note: All quantities listed include turn lanes and are estimates; Payment will be based on actual field measurements and quantities received

PROJECT NO.	SHEET NO.	TOTAL NO.
2021CPT.09.09.10851	13	
2021CPT.09.10.20851	13	

### THERMOPLASTIC AND PAINT QUANTITIES

PROJECT NO	COUNTY	MAP NO	ROUTE	DESCRIPTION	TYP NO	LANES	LANE TYPE	LENGTH	WIDTH	4413000000-E	4457000000-N	4685000000-E		4695000000-E	4705000000-E	4710000000-E	4721000000-E		4725000000-E	4810000000-E		4905000000-N	
								MI	FT	WORK ZONE ADVANCE/GENERAL WARNING SIGNING	TEMPORARY TRAFFIC CONTROL	4" X 90 M WHITE THERMO	4" X 90 M YELLOW THERMO	8" X 90 M YELLOW THERMO	16" X 120 M WHITE THERMO	24" X 120 M WHITE THERMO	THERMO MSG SCHOOL 120 M	THERMO RXR 120 M	THERMO LT ARROW 90 M	4" WHITE PAINT	4" YELLOW PAINT	SNOW PLOWABLE MARKERS	
									SF	LS	LF	LF	LF	LF	EA	EA	EA	LF	LF	EA			
2021CPT.09.09.10851	Stokes	1	NC8	FROM FORSYTH COUNTY LINE TO PVT JOINT E DOLLAR GENERAL, FROM PVT JOINT S BRIDGE#14 TO BOLEJACK RD SR1961	2, 4	2, 3	2WU	3.826	24	872	1	41,168	41,168	120		374	36		7	860	860	275	
<b>TOTAL FOR MAP NO. 1</b>								<b>3.826</b>		<b>872</b>	<b>1</b>	<b>41,168</b>	<b>41,168</b>	<b>120</b>		<b>374</b>	<b>36</b>		<b>7</b>	<b>860</b>	<b>860</b>	<b>275</b>	
2021CPT.09.09.10851	Stokes	2	NC8	FROM BOLEJACK RD SR 1961 TO ROSEBUD RD SR 1945	3	2,3	2WU	1.875	24	422		19,800	19,800							19,800	19,800	125	
<b>TOTAL FOR MAP NO. 2</b>								<b>1.875</b>		<b>422</b>		<b>19,800</b>	<b>19,800</b>								<b>19,800</b>	<b>19,800</b>	<b>125</b>
<b>TOTAL FOR PROJ NO. 2021CPT.09.09.10851</b>								<b>5.701</b>		<b>1,294</b>	<b>1</b>	<b>60,968</b>	<b>60,968</b>	<b>120</b>		<b>374</b>	<b>36</b>		<b>7</b>	<b>20,660</b>	<b>20,660</b>	<b>400</b>	
											<b>121,936</b>				<b>36</b>		<b>41,320</b>						
2021CPT.09.10.20851	Stokes	3	PERCH RD SR1147	FROM SURRY COUNTY LINE TO OLD US52 SR1236	2	2	2WU	1.937	22	218		20,842	20,842		150	75		6		420	420		
<b>TOTAL FOR MAP NO. 3</b>								<b>1.937</b>		<b>218</b>		<b>20,842</b>	<b>20,842</b>		<b>150</b>	<b>75</b>		<b>6</b>		<b>420</b>	<b>420</b>		
2021CPT.09.10.20851	Stokes	4	DAN GEORGE RD SR 1484	FROM MOORE SPRINGS RD SR1001 TO NC268	2	2	2WU	1.856	21	416		19,971	19,971										
<b>TOTAL FOR MAP NO. 4</b>								<b>1.856</b>		<b>416</b>		<b>19,971</b>	<b>19,971</b>										
2021CPT.09.10.20851	Stokes	5	TRINITY CHURCH RD SR1102	FROM W OF CALLOWAY RD SR1106 TO SPAINHOUR MILL RD SR1100/PERCH RD SR1101	2	2	2WU	3.317	22	779		35,691	35,691										
<b>TOTAL FOR MAP NO. 5</b>								<b>3.317</b>		<b>779</b>		<b>35,691</b>	<b>35,691</b>										
2021CPT.09.10.20851	Stokes	6	SPAINHOUR MILL RD SR1101	FROM FORSYTH COUNTY LINE TO SURRY COUNTY LINE	1	2	2WU	1.934	21	217		20,810	20,810										
<b>TOTAL FOR MAP NO. 6</b>								<b>1.934</b>		<b>217</b>		<b>20,810</b>	<b>20,810</b>										
2021CPT.09.10.20851	Stokes	7	MOORE SPRING RD SR1001	FROM HANGING ROCK PARK RD SR2015 TO NC66	2	2	2WU	5.377	20	603		57,857	57,857										
<b>TOTAL FOR MAP NO. 7</b>								<b>5.377</b>		<b>603</b>		<b>57,857</b>	<b>57,857</b>										
<b>TOTAL FOR PROJ NO. 2021CPT.09.10.20851</b>								<b>14.421</b>		<b>2,233</b>		<b>155,171</b>	<b>155,171</b>	<b>150</b>	<b>75</b>		<b>6</b>		<b>420</b>	<b>420</b>			
											<b>310,342</b>				<b>6</b>		<b>840</b>						
<b>GRAND TOTAL</b>								<b>20.122</b>		<b>3,527</b>	<b>1</b>	<b>216,139</b>	<b>216,139</b>	<b>120</b>	<b>150</b>	<b>449</b>	<b>36</b>	<b>6</b>	<b>7</b>	<b>21,080</b>	<b>21,080</b>	<b>400</b>	
											<b>432,278</b>				<b>42</b>		<b>42,160</b>						

Note: All quantities listed include turn lanes and are estimates; Payment will be based on actual field measurements and quantities received

# SIGNING FOR RESURFACING PROJECTS

**LEGEND**  
 ┆ STATIONARY SIGN  
 ┆ DIRECTION OF TRAFFIC FLOW

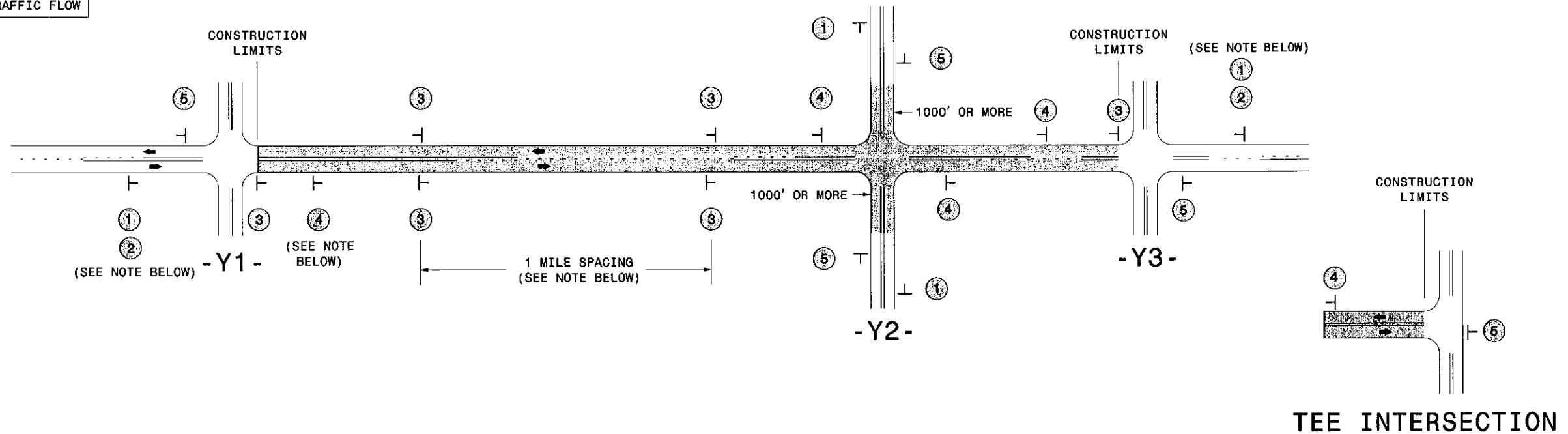

## MAINLINE (-L-) SIGNING

## -Y- LINE SIGNING

SIGNING NOTES AND PLACEMENT PER DIRECTION	 	<p>PLACE 1000' PRIOR TO BEGINNING OF CONSTRUCTION LIMITS. ONLY USED ON -Y- LINES IF RESURFACING LIMITS EXTEND 1000' ALONG -Y- LINE.</p> <p>#2 SIGN ONLY USED WHEN CONSTRUCTION LIMITS ARE 2 OR MORE MILES IN LENGTH. ROUND UP TO NEXT WHOLE NUMBER. (NO FRACTIONAL OR DECIMAL NUMBERS)</p>	<p>NO REQUIRED STATIONARY SIGNING FOR THE FOLLOWING -Y- LINE CONDITIONS:</p> <ol style="list-style-type: none"> <li>1) LESS THAN 1000' OF RESURFACING ALONG -Y- LINE</li> <li>2) SUBDIVISION ROADS</li> <li>3) DEAD END ROADS</li> </ol> <p>WHEN PAVING/CONSTRUCTION ACTIVITIES PROCEED ACROSS AN UNSIGNED -Y- LINE, PORTABLE ADVANCE WARNING SIGNS SHALL BE USED ALONG THE -Y- LINE AS SHOWN BELOW. REMOVE UPON COMPLETION OF WORK.</p> <div style="display: flex; justify-content: space-around;"> <div style="text-align: center;">             PLACED 500' IN ADVANCE OF FLAGGER.         </div> <div style="text-align: center;">             PLACED 250' IN ADVANCE OF FLAGGER.         </div> </div>
		<p>- PLACE INITIALLY AT THE CONSTRUCTION LIMITS AND SPACE 1 MILE APART THEREAFTER.</p> <p>- AT TEE INTERSECTIONS INSTALL INITIALLY 1/2 MILE FROM INTERSECTION AND SPACE 1 MILE APART THEREAFTER.</p>	
		<p>- THESE ARE FOR -Y- LINES THAT ARE "THROUGH" ROADWAYS. DEAD END AND SUBDIVISION ROADS ARE NOT "THROUGH" ROADWAYS.</p> <p>- INSTALL 500' +/- FROM EACH -Y- LINE APPROACH AS SHOWN ABOVE.</p> <p>- FOR MULTIPLE -Y- LINES THAT ARE SEPARATED BY 0.25 MILES OR LESS, TREAT AS A SINGLE UNIT AND INSTALL WITHIN 500' OF EACH APPROACH.</p> <p>- A MAXIMUM OF 2 SIGN SETS PER MILE. DO NOT INSTALL WHEN -Y- LINES ARE WITHIN 0.5 MILES FROM "END ROAD WORK" SIGN.</p> <p>- FOR TEE INTERSECTIONS, INSTALL WITHIN 500' +/- OF THE INTERSECTION ALONG -L- LINE.</p>	
		<p>PLACE 500' FOLLOWING THE END OF CONSTRUCTION LIMITS OR AS SHOWN WHEN WORK ENDS AT A 3-WAY TEE INTERSECTION.</p>	

THE ABOVE SIGNS ARE ALL THAT ARE REQUIRED FOR A CONTRACTOR TO BEGIN A RESURFACING CONTRACT. ANY ADDITIONAL SIGNS REQUESTED BY NCDOT DIVISIONS SHALL BE INSTALLED WITHIN 7 BUSINESS DAYS OF THE START OF CONTRACT WORK.

**MAPS LESS THAN 2 MILES**

FOR RESURFACING MAPS WITH CONSTRUCTION LIMITS LESS THAN 2 MILES IN LENGTH, NO STATIONARY SIGNS ARE REQUIRED. USE PORTABLE "ROAD UNDER CONSTRUCTION" OR "ROAD WORK AHEAD" SIGNS IN LIEU OF STATIONARY ADVANCE WARNING SIGNS.

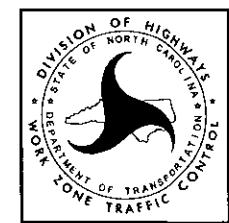

**ADVANCE WARNING SIGNS FOR RURAL AND SUBURBAN 2-LANE ROADWAY RESURFACING**

5/15/2017 3:41:00 PM WZTC:Resurfacing\2L2W & AST Resurfacing Details\Resurfacing\_AdvWarn\_2Ln.dgn User:Kacalis